



Description

- Two-stage progressive mechanical forced draught burner.
- Fuel: natural gas, net calorific value 8,83 ... 10,53 kWh/m³,
- Maximum heat power: 1 850, 2 200 and 2 900 kW.
- Minimum / maximum power ratio: 1/5.
- Adjustable combustion head length with sliding flange.
- Burner head adjustments preserved during maintenance.
- Closing of the air damper on burner shut-down.
- Security box with base, to be integrated in electrical switching cabinet.
- Gas train factory assembled and tested for tightness and electrical security (definition, description and dimensions : see Gas train chapter).
- Three-phase electrical power supply.
- Protection level IP 20.
- Maximum working temperature 60°C.
- In compliance with the EN 676 norm and European Guidelines such as:
 - low voltage 73/23/EC
 - EMC 2004/108/EC
 - gas appliances 90/396/EC

Connecting flange

| Type | Ø a (mm) | Ø b (mm) | c | d |
|---------------|----------|----------|-----|-----|
| EK 5.180 G-RO | 230 | 340 | M12 | 45° |
| EK 5.200 G-RO | 270 | 340 | | |
| EK 5.280 G-RO | 330 | 406 | | |

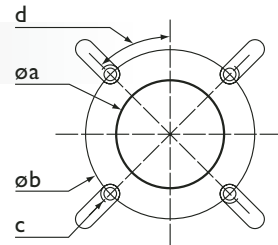

Packaging

The complete burner is delivered wrapped up on a pallet with:

- Gas train and filter,
- Boiler fixing accessories,
- Directions for use including electrical diagram, exploded view & spare parts list..

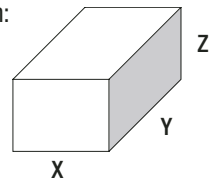

| Type | Dimensions (mm) | | | Gross weight (kg) |
|-------------------|-----------------|------|-----|-------------------|
| | X | Y | Z | |
| EK 5.180/220 G-RO | 1530 ... 1780 | 1540 | 750 | 160 ... 195 |
| EK 5.280 G-RO | | | | 170 ... 205 |

Dimensions

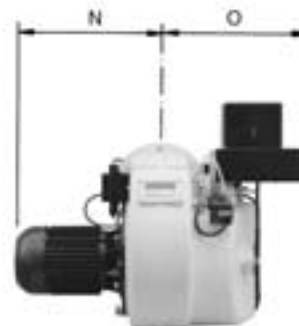
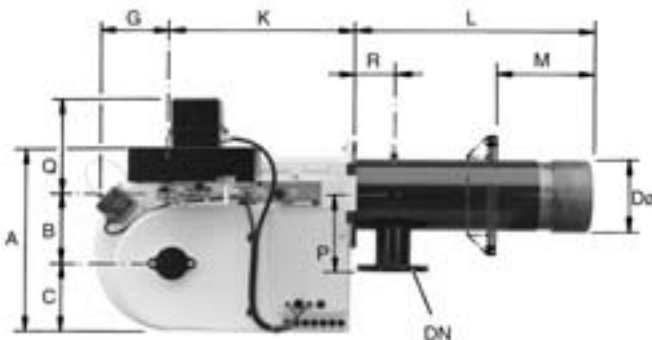

| Type | Dimensions (mm) | | | | | | | | | | | | | |
|---------------|-----------------|-----|-----|-----|-----|-----|-----|-------------|-----|-----|-----|-----|-----|----|
| | A | B | C | ØD | G | K | L | M | N | O | P | Q | R | DN |
| EK 5.180 G-RO | 490 | 173 | 206 | 220 | 242 | 500 | 565 | 250 ... 450 | 420 | 360 | 300 | 333 | 100 | 80 |
| EK 5.220 G-RO | | | | 261 | | | 585 | 270 ... 470 | 420 | | 300 | | | |
| EK 5.280 G-RO | | | | 323 | | | 571 | 250 ... 481 | 470 | | 333 | | | |



Range : EK 5. ... G-RO
 EK 5.180 G-RO, EK 5.220 G-RO, EK 5.280 G-RO
 165 ... 2900 kW
 2 stage progressive mechanical
 Natural gas

Working fields

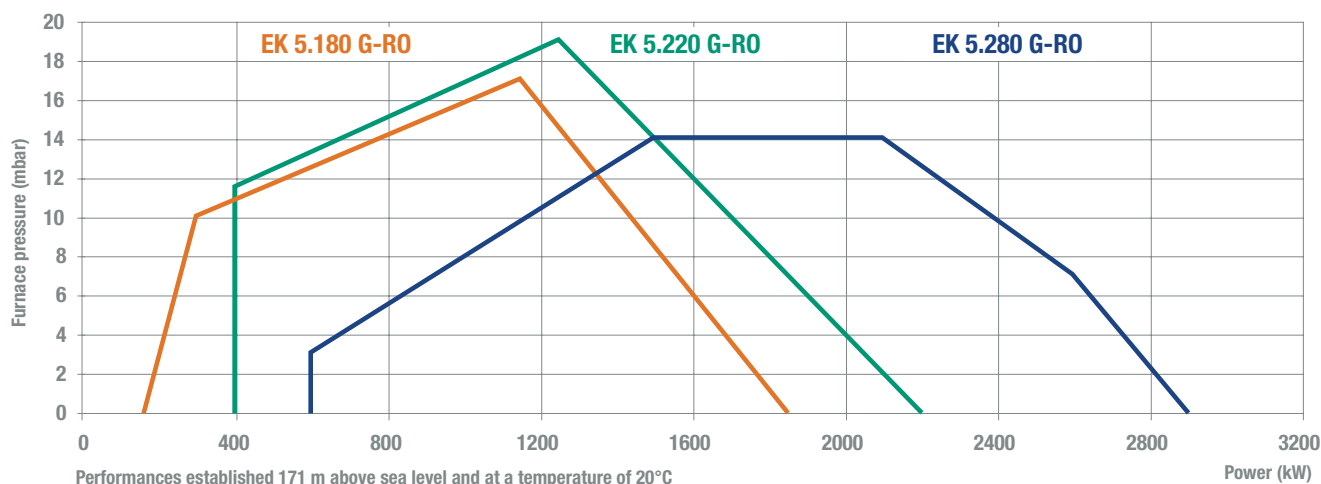

Characteristics and equipment

| Type | EK 5.180 G-RO | EK 5.220 G-RO | EK 5.280 G-RO |
|---------------------------------------|---------------------------------------|---------------|--|
| Operating range | 165 - 1850 kW | 400 - 2200 kW | 600 - 2900 kW |
| Control box / flame detector | LFL 1.333 / QRA2 | | |
| Fan motor | 2800 rpm - 400/690 V - 50 Hz - 4,0 kW | | 2800 rpm - 400/690 V 50 Hz - 5,5 kW |
| Electrical consumption | 4,7 kVA | | 6,5 kVA |
| Emission grade (according to EN 676) | Class 3 | | |
| Order-No | 1 008 579 | 1 008 580 | 1 008 591 |
| Gas valve natural gas 20 ... 300 mbar | refer to "Gas train" chapter | | |

Options

| | | |
|-----------------------|-----------------------|---------------|
| Sound proofing box | 15 ... 20 dB(A) | 1 148 747 931 |
| | 20 ... 30 dB(A) | 1 148 747 737 |
| Steam equipment (TRD) | | 1 007 678 |
| Others | see chapter "Options" | |

Documentation

| | | |
|-------------------------------|----|--------------|
| Directions for use | EN | 102 885 0599 |
| Exploded view and spare parts | EN | 123 106 |
| Electrical diagram | EN | |

Basic spare parts

| | | |
|----------------------|----------|--------------|
| Ignition transformer | | 173 819 7791 |
| Ignition electrode | | 218 357 |
| Baffle plate (kit) | EK 5.180 | 219 020 |
| | EK 5.220 | 218 350 |
| | EK 5.280 | 215 501 |
| Control box | | 263 598 |
| Flame detector | | 13 012 980 |